

STANDARD CONSTRUCTION
FRAME:

6063T5 EXTRUDED ALUMINUM
 NOMINAL WALL THICKNESS OF 0.075"
 UNIVERSAL 1-1/4" FLANGE

BLADES:

6063T5 EXTRUDED ALUMINUM
 NOMINAL WALL THICKNESS OF 0.092"
 SPACED AT APPROX. 1/2" CENTERS
 ALL SIZES INCLUDE REMOVABLE CORE

STANDARD NECK SIZES:

2" MINIMUM
 12" MAXIMUM

STANDARD FACE SIZES:

12" MINIMUM
 72" MAXIMUM

FINISH:

SKY WHITE (STANDARD)
 MILL FINISH (OPTIONAL).

AXALTA 100% POLYESTER POWDER COATING GIVES AN ATTRACTIVE BRIGHT WHITE FINISH AND PROVIDES ADDITIONAL PROTECTION FROM AGING AND WEAR.

OPTIONS:

STEEL OPPOSED BLADE DAMPER (OBD)
 * FOR MORE DETAILS SEE SUBMITTAL "OBD"

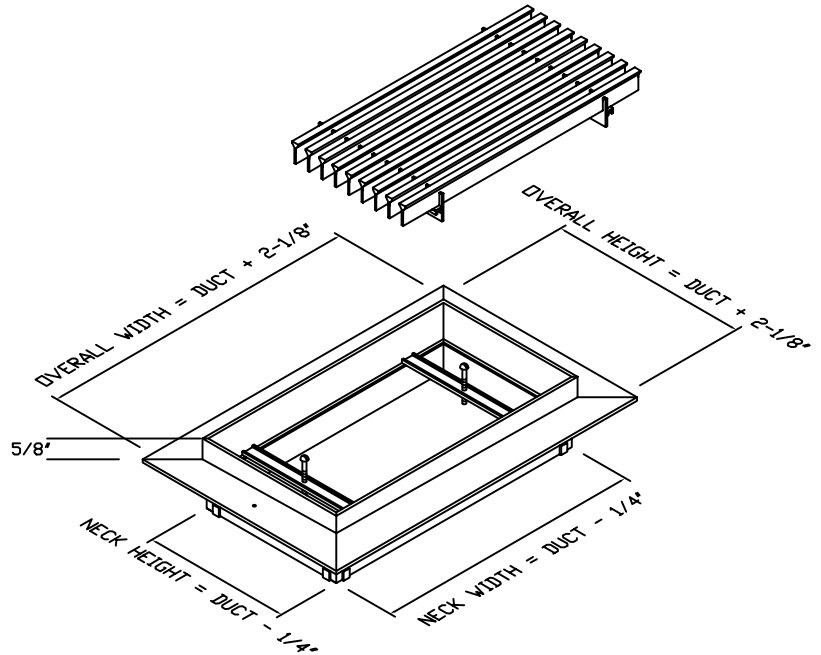
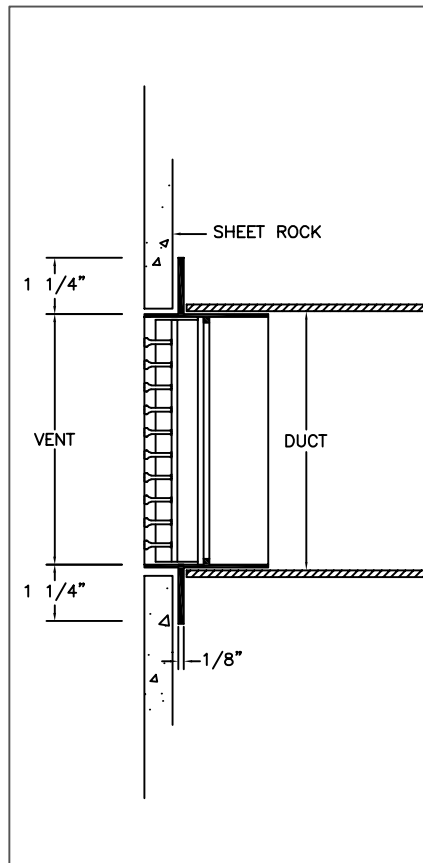
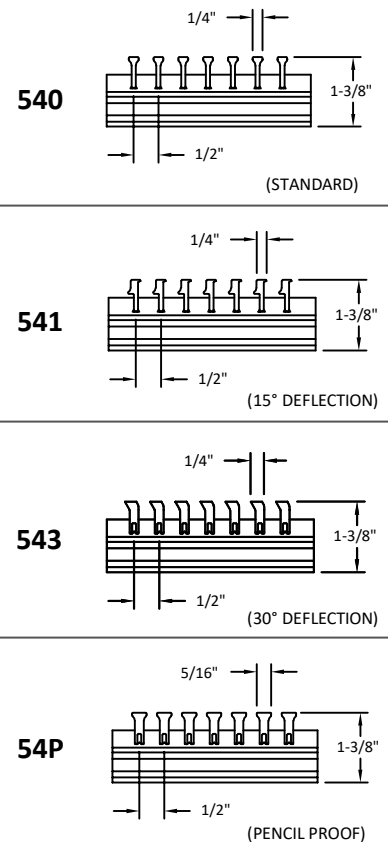
FLANGE

CORE STYLES

JOB NAME:
LOCATION:
ARCHITECT:
ENGINEER:
CONTRACTOR:
CONTACT GRILLE TECH INC. FOR ADDITIONAL INFORMATION OR WITH SPECIAL REQUIREMENTS.
5101 NW 36TH AVE MIAMI, FL 33142 PHONE: 305-537-0053 FAX: 305-537-0064
WEB: WWW.GRILLETECHINC.COM EMAIL: SALES@GRILLETECHINC.COM

FRBG

FRENCH RIVIERA BAR GRILLE
 PRODUCT SPECIFICATIONS

DRAWN BY:	MR	DATE:	5/18/17	SCALE:	NOT TO SCALE	DRAWING NO.	FRBG
CHECKED BY:	IG	DATE:	5/31/17	REVISION:	5/18/17		

Bar Grille Sidewall Supply

Sidewall Supply: 0°, 15°, and 30° Deflection

Neck Vel.	FPM	500	700	900	1000	1100	1200	1300
Neck Height	Ps	.012	.024	.040	.050	.060	.072	.084
1 1/2	CFM/Ft	20	28	36	40	44	48	52
	Pt	.016	.031	.051	.062	.075	.090	.105
	Throw/Ft	8-11	11-16	13-18	14-20	15-22	17-24	17-25
	Drop	4	5	5	4.5	5	5	5
	NC	<20	<20	20	23	26	28	31
2	CFM/Ft	30	42	54	60	66	72	78
	Pt	.016	.031	.051	.062	.075	.090	.105
	Throw/Ft	7-10	10-15	13-18	14-20	15-22	17-24	17-25
	Drop	4	5	5	5.5	5.5	5.5	6
	NC	<20	<20	20	23	26	29	31
2 1/2	CFM/Ft	45	63	81	90	99	108	117
	Pt	.016	.031	.051	.062	.075	.090	.105
	Throw/Ft	8-11	11-16	14-20	16-23	17-24	18-26	20-28
	Drop	4	5	5	5.5	5.5	5	6
	NC	<20	<20	20	23	26	29	31
3	CFM/Ft	55	77	99	110	121	132	143
	Pt	.016	.031	.051	.062	.075	.090	.105
	Throw/Ft	8-12	13-18	15-22	17-25	18-26	20-28	21-30
	Drop	5.5	6	6	6	6.5	6	6
	NC	<20	<20	20	23	26	29	31
3 1/2	CFM/Ft	65	91	117	130	143	156	169
	Pt	.016	.031	.051	.062	.075	.090	.105
	Throw/Ft	9-13	13-19	16-23	18-26	20-28	21-30	22-32
	Drop	5.5	6	6	6.5	6.5	6	6
	NC	<20	<20	20	23	26	29	31
4	CFM/Ft	80	112	144	160	176	192	208
	Pt	.016	.031	.051	.062	.075	.090	.105
	Throw/Ft	10-14	15-22	17-25	20-29	22-32	24-34	25-26
	Drop	5.5	6	6	6.5	6.5	7	7
	NC	<20	<20	20	23	26	29	31
6	CFM/Ft	125	175	225	250	275	300	325
	Pt	.016	.031	.051	.062	.075	.090	.105
	Throw/Ft	10-15	15-22	19-27	22-31	23-33	24-35	27-38
	Drop	5.5	6	6	6.5	6.5	7	8
	NC	<20	<20	20	23	26	29	31
8	CFM/Ft	175	245	315	350	385		
	Pt	.016	.031	.051	.062	.075		
	Throw/Ft	12-17	17-24	20-28	23-33	24-34		
	Drop	5.5	6	6.5	6.5	7		
	NC	<20	<20	20	23	26		
10	CFM/Ft	225	315	405	450			
	Pt	.016	.031	.051	.062			
	Throw/Ft	13-19	20-28	23-33	26-37			
	Drop	7.5	8	8.5	8.5			
	NC	<20	<20	20	23			
12	CFM/Ft	275	385	495				
	Pt	.016	.031	.051				
	Throw/Ft	15-21	24-35	27-38				
	Drop	7.5	8	9				
	NC	<20	<20	20				

Notes:

1. Data based on bar grille installed in a sidewall 1 ft. below a 9 ft. ceiling, supplying air across a unobstructed ceiling surface.
2. Throw based on a 4 ft. grille. For less than 4 ft., subtract 20% per foot shorter. For longer, add 20% up to 60%.
3. Drop based on 0° deflection supply air with 20° cooling differential. Drop for 15° and 30° deflection is approximately 40% less than shown (Blade Deflection to ceiling).
4. NC based on 4 ft. grille. For larger grilles, add 1.5 NC per foot to a max 5 NC. For smaller than 4 ft., subtract 3 NC per foot.

Bar Grille Sill Supply

Sill Supply: 0°, 15°, and 30° Deflection

Neck Vel.	FPM	500	700	900	1000	1100	1200	1300
Neck Height	Ps	.012	.024	.040	.050	.060	.072	.084
1 1/2	CFM/Ft	20	28	36	40	44	48	52
	Pt	.016	.031	.051	.062	.075	.090	.105
	Throw/Ft	6-9	9-13	10-14	11-16	13-18	13-19	14-20
	NC	<20	<20	20	23	26	29	31
2	CFM/Ft	30	42	54	60	66	72	78
	Pt	.016	.031	.051	.062	.075	.090	.105
	Throw/Ft	5-8	8-12	10-14	11-16	13-18	13-19	14-20
	NC	<20	<20	20	23	26	29	31
2 1/2	CFM/Ft	45	63	81	90	99	108	117
	Pt	.016	.031	.051	.062	.075	.090	.105
	Throw/Ft	6-9	9-13	11-16	13-18	13-19	15-21	15-22
	NC	<20	<20	20	23	26	29	31
3	CFM/Ft	55	77	99	110	121	132	143
	Pt	.016	.031	.051	.062	.075	.090	.105
	Throw/Ft	7-10	10-14	13-18	14-20	15-21	15-22	17-24
	NC	<20	<20	20	23	26	29	31
3 1/2	CFM/Ft	65	91	117	130	143	156	169
	Pt	.016	.031	.051	.062	.075	.090	.105
	Throw/Ft	7-10	10-15	13-18	15-21	15-22	17-24	18-26
	NC	<20	<20	20	23	26	29	31
4	CFM/Ft	80	112	144	160	176	192	208
	Pt	.016	.031	.051	.062	.075	.090	.105
	Throw/Ft	8-11	13-18	14-20	16-23	18-26	19-27	20-29
	NC	<20	<20	20	23	26	29	31
6	CFM/Ft	125	175	225	250	275	300	325
	Pt	.016	.031	.051	.062	.075	.090	.105
	Throw/Ft	8-12	13-18	15-22	17-25	18-26	20-28	21-30
	NC	<20	<20	20	23	26	29	31
8	CFM/Ft	175	245	315	350	385		
	Pt	.016	.031	.051	.062	.075		
	Throw/Ft	10-14	13-19	15-22	18-26	19-27		
	NC	<20	<20	20	23	26		
10	CFM/Ft	225	315	405	450			
	Pt	.016	.031	.051	.062			
	Throw/Ft	10-15	15-22	18-26	21-30			
	NC	<20	<20	20	23			
12	CFM/Ft	275	385	495				
	Pt	.016	.031	.051				
	Throw/Ft	12-17	21-31	22-38				
	NC	<20	<20	20				

Notes:

1. Data based on a bar grille installed horizontally on the top surface of a 30" high sill enclosure and supplying air vertically toward a 9 ft ceiling.
2. Throw values shown are the sum of vertical distance from the grille to ceiling plus the horizontal distance the mixed air moves out across the ceiling. For comfort throw values selected should reach the ceiling and move out horizontally a distance of 10 to 15 feet from the active wall.
3. NC shown is based on a 4ft grille. NC for larger units, add 1.5 NC per foot over 4' up to 5 NC larger than shown. For shorter than 4', subtract 3 NC per foot under 4'.