

PERFORATED CEILING DIFFUSERS

STEEL. FIRE RATED DAMPER (UL R.10967). LAY-IN FACE.



UNDERWRITERS LABORATORIES INC.
CLASSIFIED
CEILING RADIATION DAMPERS
TESTED IN ACCORDANCE WITH UL 263

PAGE
1 OF 2

CEILING GRID LAYOUT:

1. NO DIFFUSER SHALL BE LOCATED IN AN ADJACENT 24" X 48" CEILING GRID MODULE.

24"X24"
SUPPLY/RETURN
CEILING MODULE

DUCT SIZE D

22" X 22"

MODEL 615 FIRE DAMPER

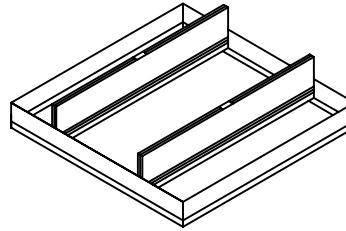

MODEL 615
FIRE DAMPER

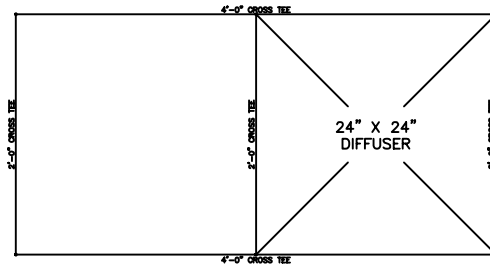
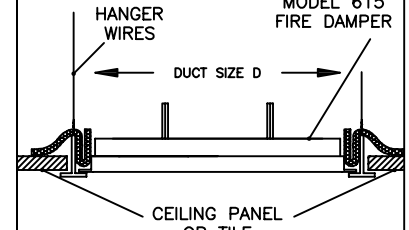

HANGER WIRES
(TYPICAL)

REMOVING PERFORATED FACE

STEP 1:
USE A SMALL SCREWDRIVER OR OTHER INSTRUMENT TO PUSH LATCH INWARD FROM BORDER. REPEAT ON OPPOSITE SIDE.

STEP 2:
FACE WILL SWING DOWN WITH THE TWO REMAINING LATCHES ACTING AS HINGES. FOR COMPLETE REMOVAL, RELEASE 2 REMAINING LATCHES.

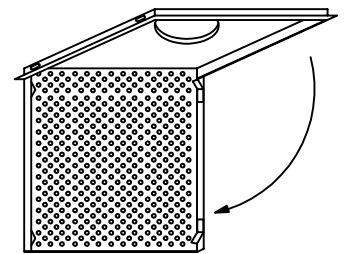
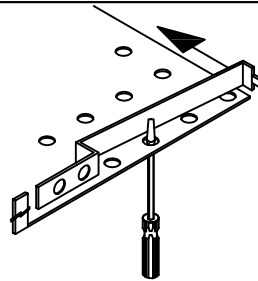

GENERAL DESCRIPTION

- THE CEILING DAMPER HAS A FIRE RESISTANCE RATING OF 3 HOURS OR LESS WHEN INSTALLED IN ACCORDANCE WITH THE INSTALLATION INSTRUCTIONS.
- THE FLUSH FACE PERFORATED CEILING DIFFUSER IS DESIGNED TO PROVIDE A UNIFORM CIRCULAR PATTERN.
- EXCELLENT PERFORMANCE IN VARIABLE AIR VOLUME SYSTEMS.
- A TIGHT AND UNIFORM HORIZONTAL BLANKET OF AIR PROTECTS THE CEILING AGAINST SMUDGING.
- PERFORATED FACE HAS 3/16" DIAMETER HOLES ON 1/4" STAGGERED CENTERS.
- STANDARD FINISH IS SKY-WHITE, DUPONT 100 % POLYESTER POWDER COATING PAINT.
- MATERIAL IS 24-GAUGE STEEL.

NOTES:

1. TYPE 615 CEILING AIR DAMPER AND DIFFUSER IS TO BE INSTALLED IN A 24" X 24" GRID MODULE OF A UL CLASSIFIED STEEL SUSPENSION SYSTEM.
IT IS DESIGNED FOR USE IN A FLOOR/CEILING OR ROOF/CEILING ASSEMBLY IN WHICH THE CONCEALED SPACE BETWEEN THE CEILING AND THE UPPER FLOOR OR ROOF IS USED AS THE SUPPLY OR RETURN AIR PLENUM.
2. THE END TABS OF THE 2'-0" CROSS TEE FORMING THE GRID MODULE FOR INSTALLATION OF THE DIFFUSER SHALL BE BENT BACK AGAINST THE WEB OF THE 4'-0" CROSS TEES. THE 4'-0" CROSS TEES MUST HAVE A SLOT AT MID-LENGTH OF THE WEB FOR CONNECTION OF THE 2'-0" CROSS TEES.
3. USE 12-GAUGE GALVANIZED STEEL HANGER WIRES AT THE CORNERS OF THE GRID MODULES CONTAINING THE CEILING AIR DIFFUSER TO SUPPORT THE UNIT FROM THE JOISTS OR BEAMS FROM THE FLOOR OR ROOF ABOVE. WIRES MUST HANG VERTICALLY, NOT DIAGONALLY.
4. MAXIMUM SIZE OF THE FIRE RATED CEILING AIR DAMPER, MODEL 615 IS 24" X 24".
5. NO DUCTLESS CEILING AIR DIFFUSER SHALL BE LOCATED IN AN ADJACENT 24" X 48" CEILING GRID MODULE.
6. UL CLASSIFIED MODEL 615 CEILING AIR DAMPER AND DIFFUSER MAY BE SUBSTITUTED OR EACH 113 SQ. IN. OR LARGER STEEL DUCT OUTLET PRODUCED WITH A HINGED SHEET METAL DAMPER IN ANY FLOOR/CEILING OR ROOF/CEILING DESIGN WITH A RESTRAINED OR UNRESTRAINED ASSEMBLY RATING OF 3H OR LESS

PR615

DUCTLESS RETURN AIR CEILING DIFFUSER
INSTALLATION INSTRUCTIONS

NOTE: ALL DRAWINGS SUBJECT TO CHANGE WITHOUT PRIOR NOTICE.



Grille tech inc.

DRAWN BY:

AF

DATE:

03/11/04

SCALE:

NOT TO SCALE

DRAWING NO.

PF8

CHECKED BY:

AV

DATE:

02/11/13

REVISION:

3

PERFORATED CEILING DIFFUSERS

STEEL. FIRE RATED DAMPER (UL R.10967). LAY-IN FACE.



UNDERWRITERS LABORATORIES INC.
CLASSIFIED
CEILING RADIATION DAMPERS
TESTED IN ACCORDANCE WITH UL 263

PAGE
2 OF 2

24"X24" SUPPLY/RETURN CEILING MODULE
DUCT SIZE D
22" X 22"

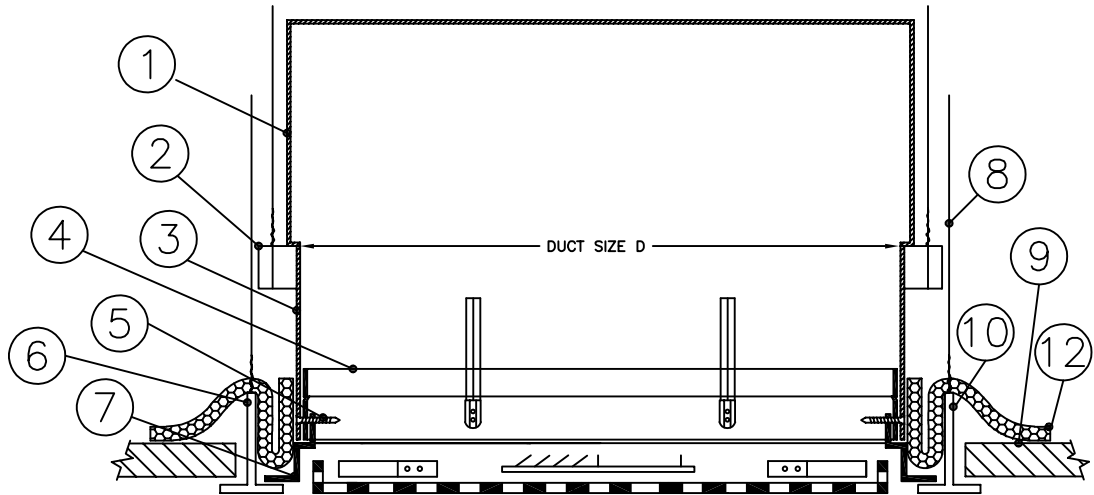

PARTS:

1. STEEL DUCT
2. SUPPORT CHANNEL OR ANGLE (2 REQUIRED)
3. STEEL DUCT DROP
4. MODEL 615 (SQUARE) CEILING DAMPER
5. MOUNTING SCREWS
6. MAIN T-BAR RUNNER
7. LAY-IN TYPE STEEL DIFFUSER (0.027" MIN. THICKNESS) WITH SQUARE NECK
8. 12 SWG HANGER WIRES (4 REQUIRED)
9. LAY-IN TYPE ACOUSTICAL PANEL (BEARING THE UL CLASSIFICATION MARKING)
10. 4'-0" SUSPENSION CROSS TEE OF GRID MODULE
11. 2'-0" SUSPENSION CROSS TEE OF GRID MODULE
12. 30" X 30" CERAMIC FIRE BLANKET (1/2" THICK, 4 PCF)

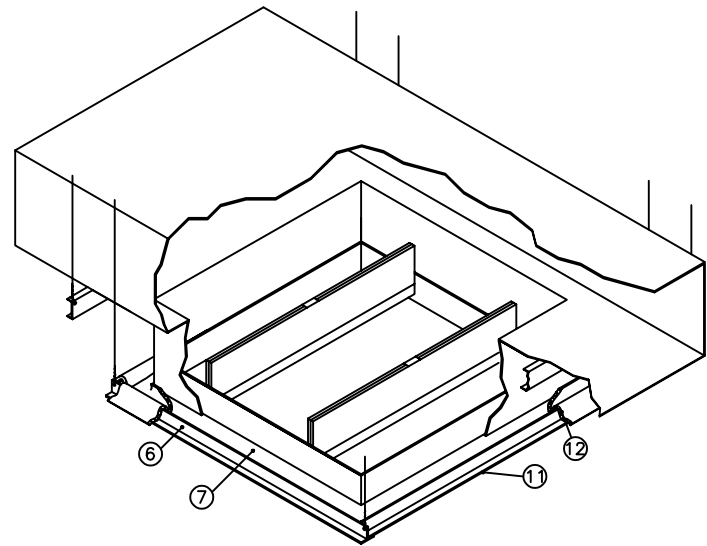

NOTES:

1. BEFORE INSTALLING DAMPER (MODEL 615) OPEN BLADES AND HOOK FUSIBLE LINK OVER CATCH ON OPPOSITE BLADE. BEND DOWN LINK CATCH TO SECURE LINK IN POSITION.
2. SUPPORT THE DUCT WITH 2 16-GAUGE COLD-ROLLED STEEL SUPPORT CHANNELS OR ANGLES. 1 1/2" OR 2" DEEP, WITH 1/2" FLANGES. PLACE THE SUPPORT CHANNELS AT THE BOTTOM OF THE DUCT ADJACENT TO BOTH SIDES OF THE DUCT DROP. USE 12 SWG GALVANIZED STEEL HANGER WIRE. SUPPORT CHANNELS FROM THE STRUCTURAL MEMBERS OF THE FLOOR OR ROOF ABOVE. THE HANGER WIRES SHALL NOT BE CROSSED AND MUST HANG STRAIGHT.
3. THE END TABS OF THE 2'-0" CROSS TEE FORMING THE GRID MODULE FOR THE INSTALLATION OF THE ASSEMBLY SHALL BE BENT BACK AGAINST THE WEB OF THE 4'-0" CROSS TEES. THE 4'-0" CROSS TEES MUST HAVE A SLOT AT MID-LENGTH OF THE WEB FOR CONNECTION OF THE 2'-0" CROSS TEES.
4. MAXIMUM NECK SIZE OF THE CEILING DIFFUSER IS 24" x 24".
5. NO DIFFUSER SHALL BE LOCATED IN AN ADJACENT 24" X 48" CEILING GRID MODULE.
6. INSTALL THE CEILING DAMPER IN THE DUCT DROP USING 3/16" DIA. X 1/2" LONG STEEL BOLTS, NO.8 X 1/2" STEEL SHEET METAL SCREWS OR 3/16" DIA. STEEL RIVETS AT 6" O.C. AND A MINIMUM OF 3 PLACES.
7. THE CLEARANCE BETWEEN THE CEILING DAMPER AND THE DUCT DROP SHALL BE 1/8" MAXIMUM.
8. SLIP THE DIFFUSER INTO THE DUCT DROP AND INSTALL NO.8 X 1/2" SHEET METAL SCREWS AT 6 INCH INTERVALS.
9. A TIGHT AND UNIFORM HORIZONTAL BLANKET OF AIR PROTECTS THE CEILING AGAINST SMUDGING.

PR615

DUCTED RETURN AIR CEILING DIFFUSER
INSTALLATION INSTRUCTIONS

NOTE: ALL DRAWINGS SUBJECT TO CHANGE WITHOUT PRIOR NOTICE.



Grille tech inc.

DRAWN BY: AF

DATE: 03/11/04

SCALE: NOT TO SCALE

DRAWING NO.

CHECKED BY: AV

DATE: 02/11/13

REVISION: 3

PF8-A