

(ENGINEER'S)  
**SUBMITTAL DATA**

**MODEL WLF-DA: 4" DEEP FIXED HURRICANE LOUVER**

MIAMI-DADE, FLORIDA NOA NO. 04-1222.01

EXPIRATION DATE: 8/11/2010

APPROVAL DATE: 8/11/2005

**MAXIMUM DESIGN PRESSURE RATING**

 SINGLE UNIT: +/- 180.0 PSF  
 MULTIPLE UNIT: +/- 160.0 PSF

PRODUCT APPROVAL IS IN ACCORDANCE WITH THE FLORIDA BUILDING CODE 2001 EDITION. DESIGN WIND LOADS SHALL BE DETERMINED AS PER SECTION 1619 OF THE ABOVE MENTIONED CODE, FOR BASIC WIND SPEEDS OF 146 MPH AND IN ACCORDANCE WITH ASCE-7-98 STANDARD.

**APPLICATIONS**

THE MODEL WLF-DA IS A WEATHER LOUVER DESIGNED TO PROTECT OPENINGS IN EXTERIOR WALLS. IT IS ENGINEERED FOR USE IN DADE COUNTY AND ITS MUNICIPALITIES AS WELL AS OTHER REGIONS THAT USE DADE COUNTY CODES. THESE LOUVERS MAY BE USED FOR EXHAUST OR INTAKE AIR. THEY ARE DESIGNED TO PROVIDE LARGE MISSILE IMPACT RESISTANCE AND ARE CONSTRUCTED OF ALUMINUM TO RESIST OXIDIZATION.

**STANDARD CONSTRUCTION**
**FRAME:**  
 6063T5 EXTRUDED ALUMINUM  
 NOMINAL WALL THICKNESS OF 0.081"  
 UNIVERSAL 1.5" FLANGE WITH A 4" DEEP FRAME  
 CAULKING SURFACE PROVIDED

**BLADES:**  
 6063T5 EXTRUDED ALUMINUM  
 NOMINAL WALL THICKNESS OF 0.081"  
 BLADES ARE POSITIONED AT 45 DEG. ANGLE  
 SPACED AT APPROX. 4" CENTERS

**BIRD SCREEN:**  
 3/4" X .051" EXPANDED ALUMINUM BIRD SCREEN  
 REMOVABLE FRAME  
 REAR (INSIDE) MOUNTING POSITION

**FINISH:**  
 MILL ALUMINUM (STANDARD)  
 SKY WHITE POWDER COAT (100% POLYESTER)  
 AVAILABLE FOR ADDITIONAL FEE

**MINIMUM SIZE\*\*:**  
 12"W X 12"H

**MAXIMUM SIZE\*\*:**  
 60"W X 80"H SINGLE SECTION  
 LARGER SIZES CAN BE MADE USING MULTIPLE SECTIONS WITH VERTICLE MULLIONS

**APPROXIMATE SHIPPING WEIGHT:**  
 10 LBS/SQ. FT. (49 KG/SQ. M.)

- OPTIONS: (AT ADDITIONAL COST)**
- INSECT SCREEN
  - SKY WHITE POWDER COAT BY DUPONT (100% POLYESTER)

**INSTALLATION:**  
 MUST COMPLY WITH INSTRUCTIONS TO MEET MIAMI-DADE PRODUCT STANDARDS.

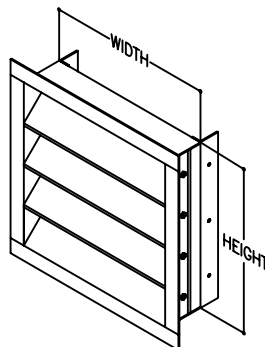
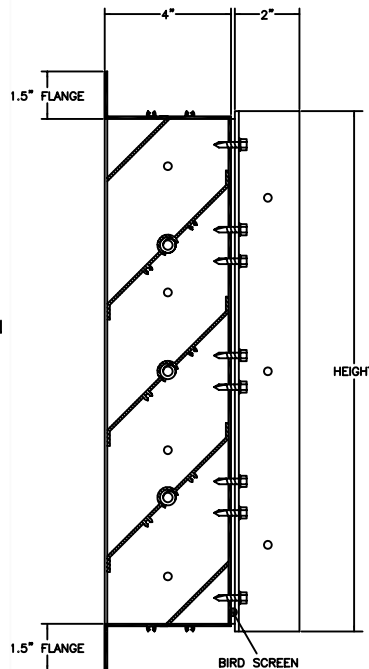
**\*\*NOTE: ACTUAL WIDTH AND HEIGHT DIMENSIONS ARE APPROXIMATELY 1/4" LESS THAN LISTED TO ALLOW FOR CLEARANCE**

**FEATURES**

HEAVY EXTRUDED ALUMINUM PROVIDES SUPERIOR PROTECTION FROM LARGE, WIND-BOURNE MISSILE IMPACT.

ONE VERTICLE CENTER REINFORCEMENT ADDED AFTER 30"W TO PROVIDE ADDITIONAL SUPPORT.

LOUVER DESIGNED FOR LOCATIONS THAT DRAIN WATER WHICH HAS PENETRATED THE ROOM. THE ROOM SHOULD HOUSE WATER RESITANT OR WATER PROOF EQUIPMENT, COMPONENTS AND/OR SUPPLIES.

FLANGED FACE ALLOWS FOR INSTALLATION IN ANY WALL THICKNESS, AND ANY MATERIAL SUBSTRATE.

ALUMINUM L-BAR ALLOWS FOR MULTIPLE ANCHORAGE LOCATIONS.

MAXIMUM SINGLE UNIT DIMENSIONS ARE 60"W X 80"H. FOR LARGER OPENINGS, LOUVERS CAN BE COMBINED USING ALUMINUM MULLIONS.

PERFORMANCE RATINGS BASED ON TESTING IN ACCORDANCE WITH MIAMI-DADE PROTOCOL'S TAS 201, 202 AND 203.

JOB NAME:
LOCATION:
ARCHITECT:
ENGINEER:
CONTRACTOR:
CONTACT GRILLE TECH INC. FOR ADDITIONAL INFORMATION OR WITH SPECIAL REQUIREMENTS. 5101 NW 36TH AVE MIAMI, FL 33142 PHONE: 305-537-0053 FAX: 305-577-0064 WEB: WWW.GRILLETECHINC.COM EMAIL: SALES@GRILLETECHINC.COM

**WLF-DA**

 ALUMINUM WALL LOUVER SYSTEM  
 ENGINEER'S SUBMITTAL DATA